

**SPECIAL FEATURES:**

- ◆ Mid-woofer unit
- ◆ Steel basket
- ◆ PP Cone
- ◆ Rubber surround
- ◆ Magnet Shielding



**SYSTEM SPECIFICATION**

Nominal Impedance	4 Ohm
DC resistance	3.6 Ohm
Nominal Power(IEC268-5)	35 W
Sensitivity(SPL 2V/1M)	87 dB
Free air resonance:Fs	58 Hz
Frequency range	FS-8K Hz
Magnet dimensions $\Phi$ *H	85*18+70*12 mm
Voice coil diameter	25.5 mm
Voice coil height	12 mm
Air gap height	5 mm
X max	3.5 mm
Effective Cone Area	92 Cm <sup>2</sup>
Moving mass(incl.air)	12.0 g
Force factor,B*L	5.8 TM
Vas	7.1 L
Qms	3.36
Qes	0.46
Qts	0.40
Weight	1250 g

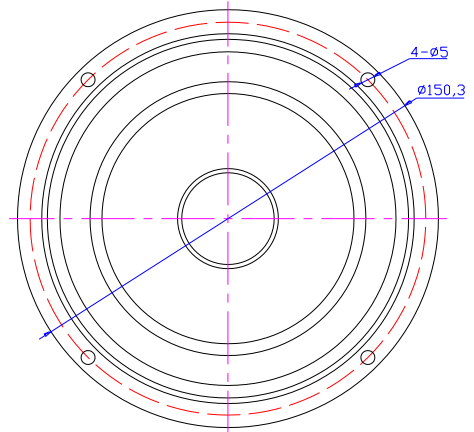
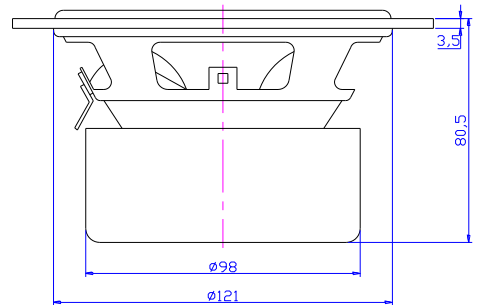

**SPL vs Freq**

